

STATE	PROJECT NUMBER	SECTION NO.	SHEET NO.
ND	BRO-8-010(036)009	170	42

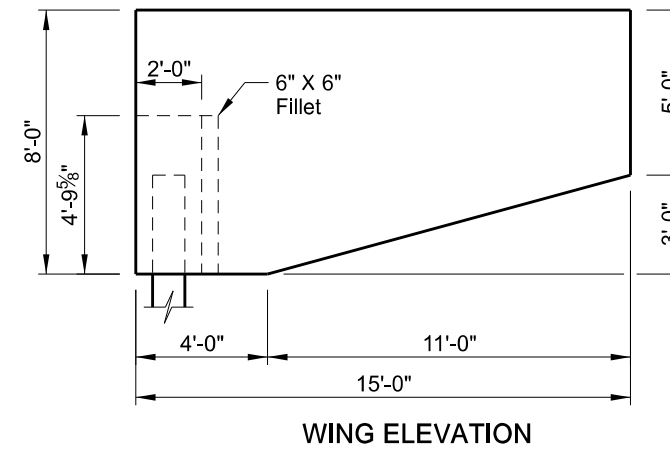
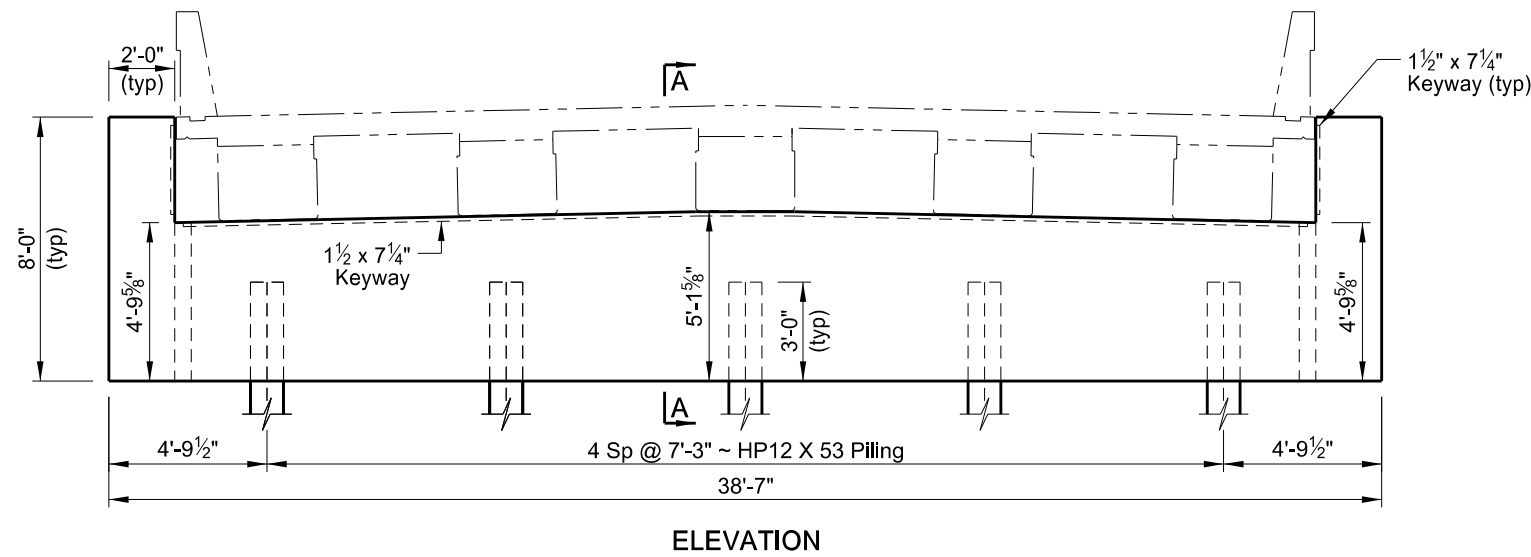
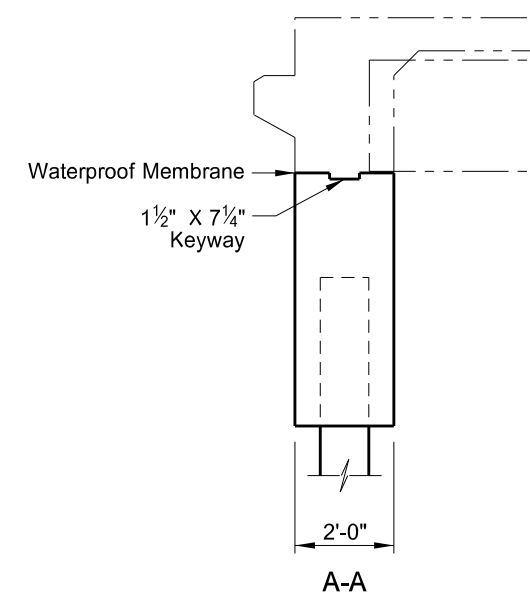
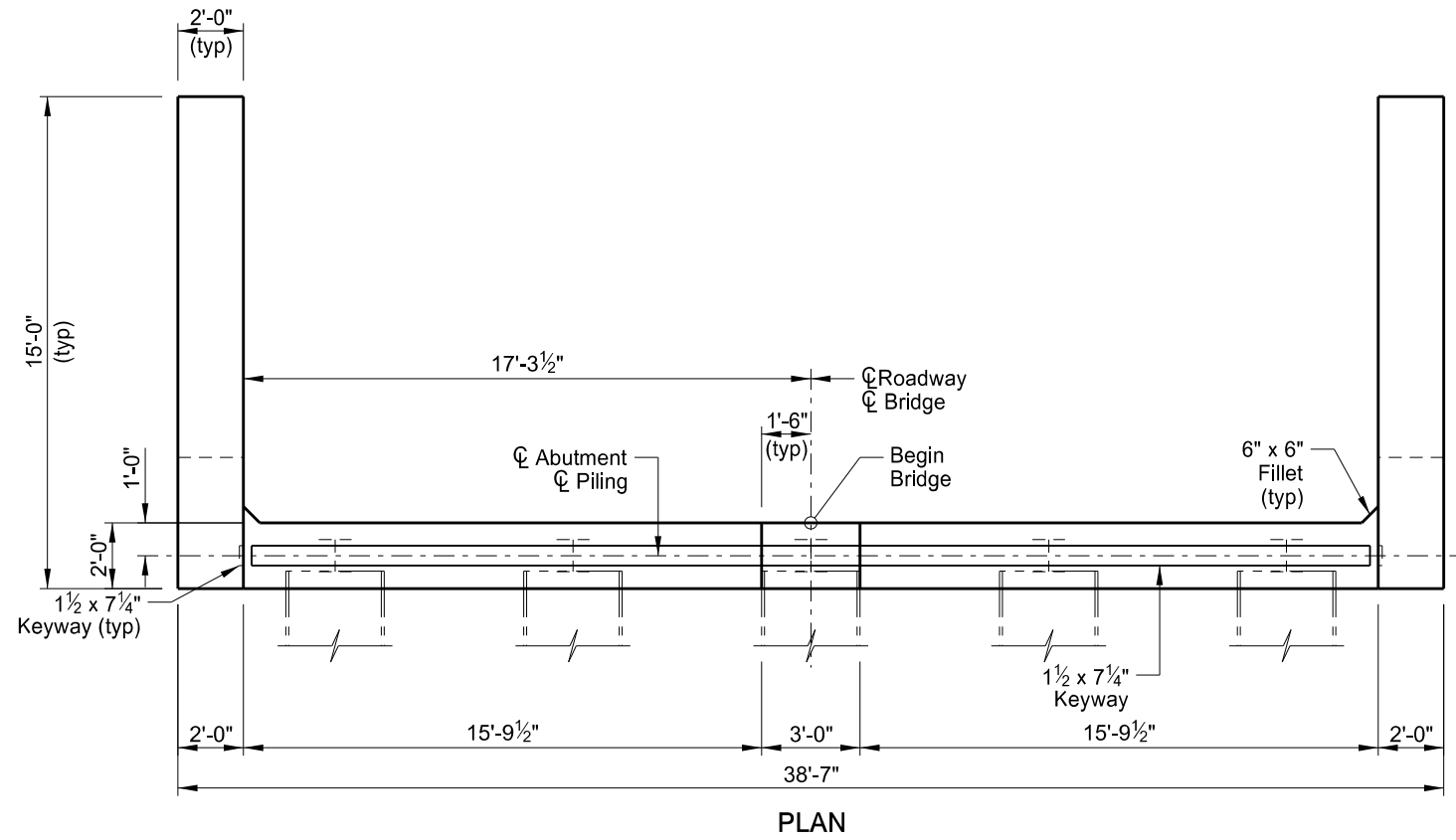

NOTE:

Use waterproof membrane that meets the requirements of Section 602.03 B.
 Center the waterproof membrane (1'-0" minimum width) on the joint.

This drawing is preliminary and not for construction or implementation purposes.

QUANTITIES
SEE DWG 10-009.014-7
MAPLE RIVER
(SHOWING DIMENSIONS)
ABUTMENT DETAILS