

STATE	PROJECT NO.	SECTION NO.	SHEET NO.
ND	Project Number	20	2

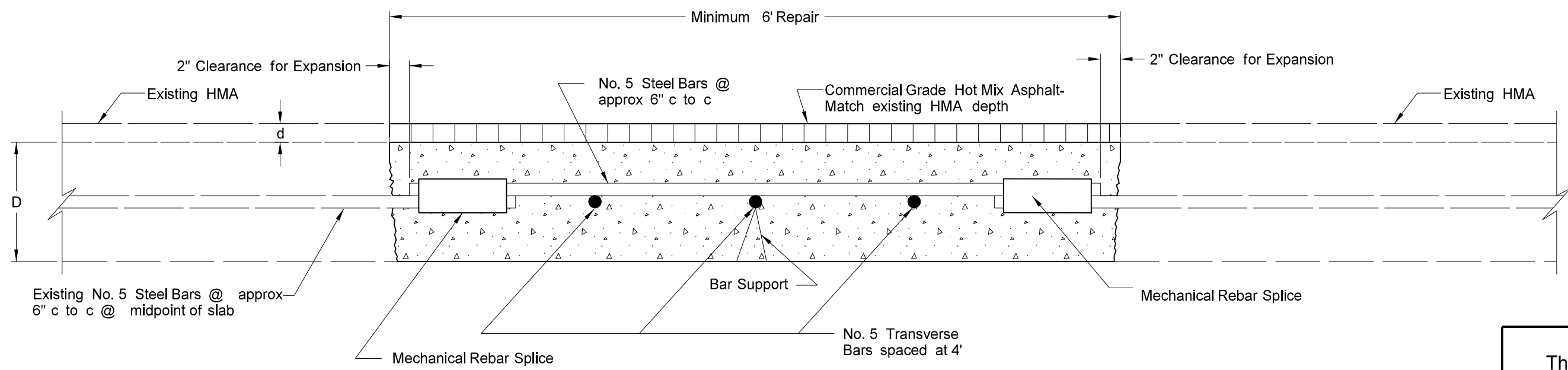
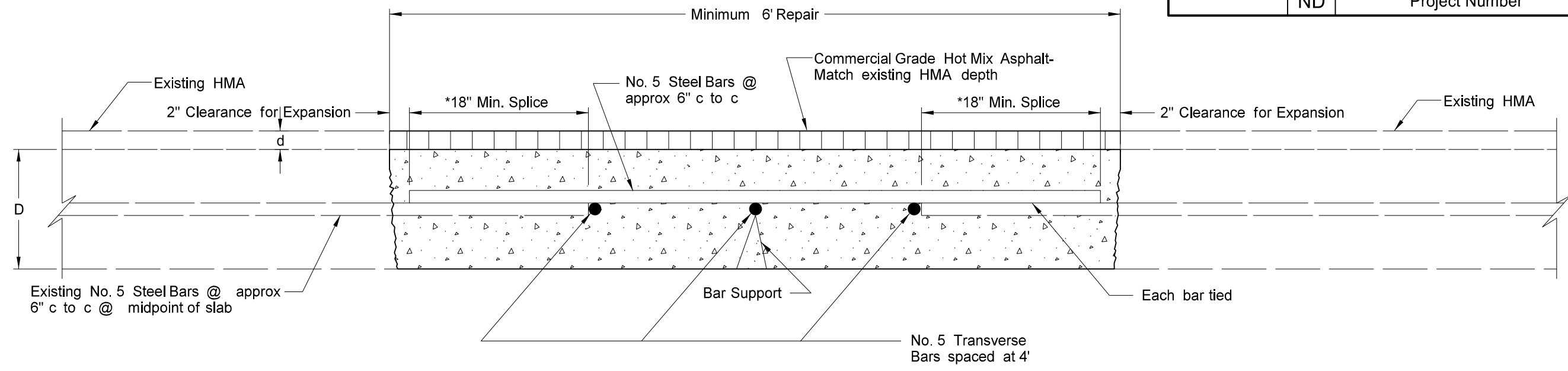

This document is preliminary and not for construction or implementation purposes.

NOTE:
Repair passing lane first when repair area includes both lanes.

* Transverse and Longitudinal Bar minimum splice length may be reduced when using Mechanical Rebar Splices.

D = PCC pavement depth
d = Hot Bituminous Pavement depth

HMA Over Continuously Reinforced Concrete Pvm
Full Depth Repair Placement Detail

Project Description

Project Location